

Apartment Area Details

SI.NO	APARTMENT NO	APARTMENT AREA Sq. Ft.	FLOOR	ROOMS	MAIN DOOR FACING
1	F1, S1 & T1	848 Sq.ft	1st 2nd & 3rd Floor	2 BHK	North
2	F2, S2 & T2	848 Sq.ft	1st 2nd & 3rd Floor	2 BHK	South
3	F3, S3 & T3	1040 Sq.ft	1st 2nd & 3rd Floor	2 BHK	North
4	F4, S4 & T4	1365 Sq.ft	1st 2nd & 3rd Floor	3 BHK	East
5	F5, S5 & T5	1206 Sq.ft	1st 2nd & 3rd Floor	3 BHK	South
6	F6, S6 & T6	1155 Sq.ft	1st 2nd & 3rd Floor	3 BHK	North
7	F7, S7 & T7	1020 Sq.ft	1st 2nd & 3rd Floor	2 BHK	East

Location Map

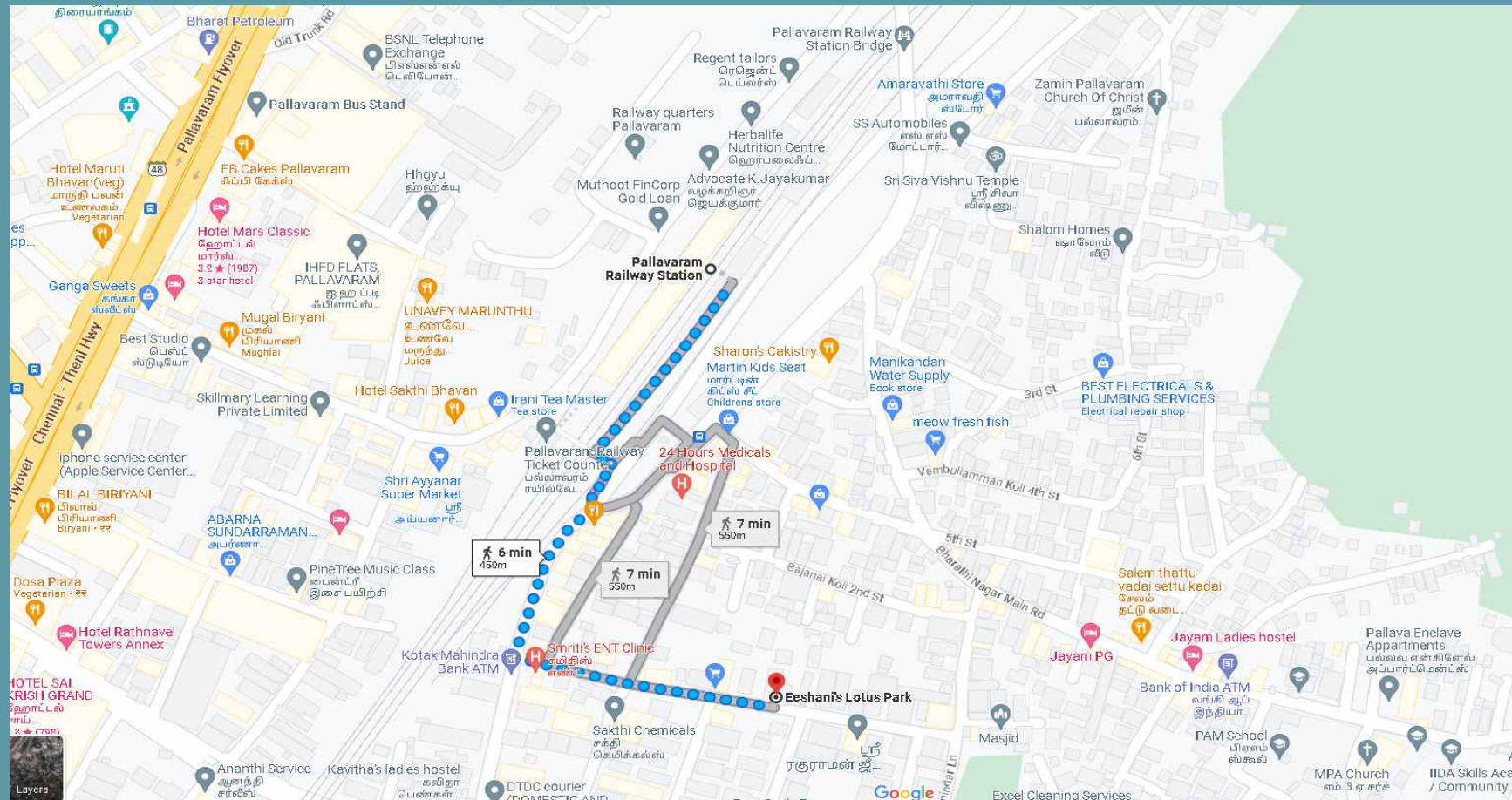

OFFICE ADDRESS :

Plot No.38, Alamelumangapuram, 2nd Cross Street,
Madipakkam, Chennai - 600091.
(Land Mark : Back side of Indusind Bank & Anjakha Hospital).

SITE ADDRESS :

New No.7, Dr. Solomon Street, Rajaji Nagar, Pallavaram, Chennai – 600 043.
LandMark: Dharga road Subway and Back side of Axis bank
100M from pallavaram railway Station.

FOR BOOKING CONTACT
M. SIVA M.E. (Structural)
9566 43 43 43
7797 01 23 45

www.eeshanibuilders.com



WWW.EESHANIBUILDERS.COM



having somewhere to go is

HOME...

having someone to love is

FAMILY...

having both is a

BLESSING...



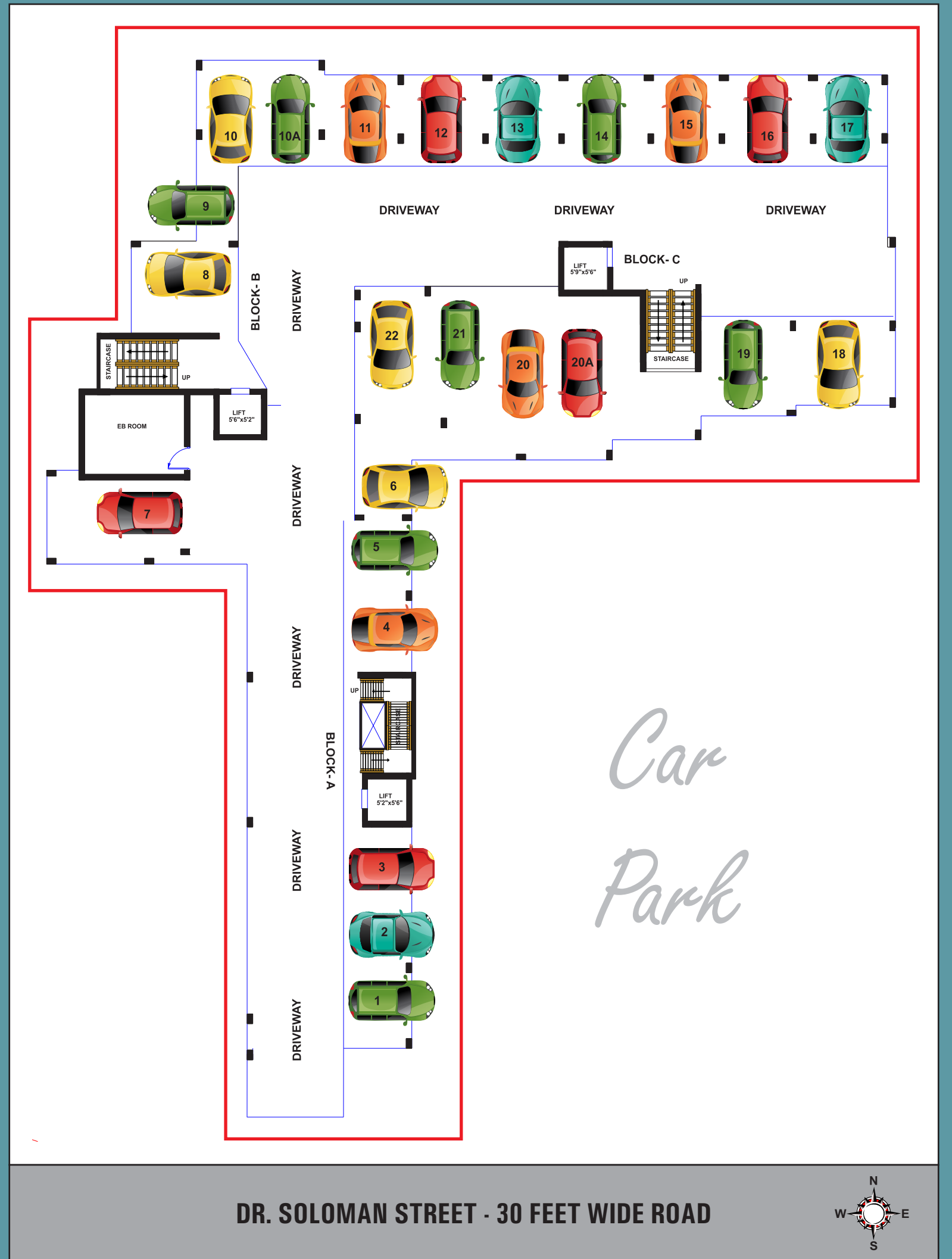

First Second & Third Floor

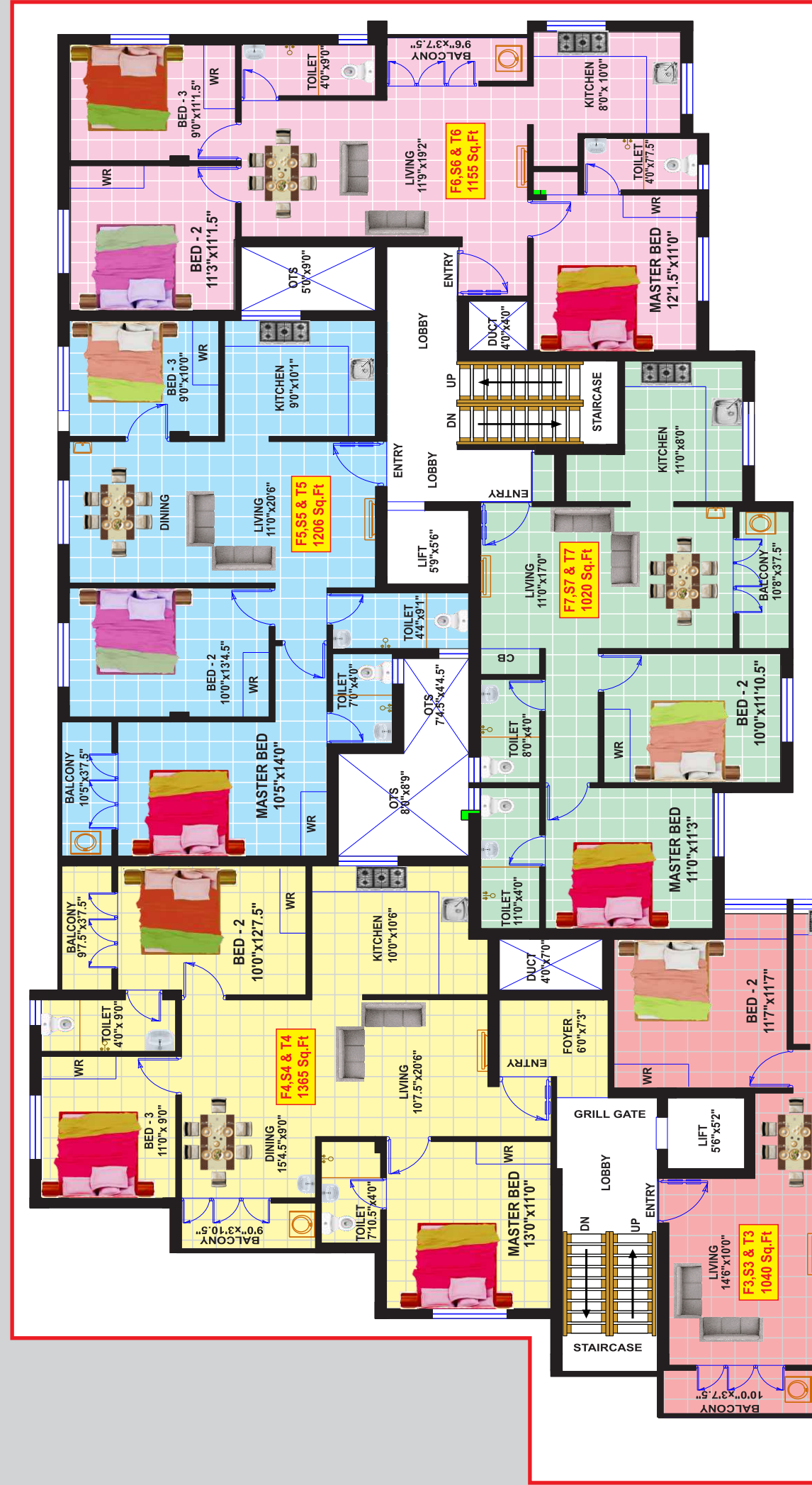

*The smile is Brought to you by
Happy LIVING...*

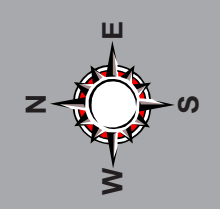

DR. SOLOMAN STREET - 30 FEET WIDE ROAD

Specification

STRUCTURE:

- R.C.C framed structure with RCC columns, beams and Slab.
- Quality Brick Masonry (Red Brick) walls using M sand.
- Covered Car Parking in Stilt floor with three floors.
- EARTH QUAKE resistant design as per STRUCTURAL CONSULTANT based on SOIL TEST REPORT.
- COLOUR, ELEVATION and DESIGNS as per Builder Choice.

SPECIAL FEATURES:

- Internal Minor Alterations, Electrical points, Plumbing fittings, Tile, Main Doors & other doors and Painting shall be of customer's choice.
- Tile provided for Ground floor car park areas for easy maintenance.
- Granite shall be provided for staircase and Stainless steel hand rails.
- Rain water harvesting.
- PEST control treatment.
- Safety Grill will be provided for Main Door and Balcony.
- Fixed supports for drying clothes in terrace.
- All bed rooms and Kitchen shall be provided with lofts.
- All bed rooms and Kitchen shall be provided with one (4 feet wide) cudappah slabs.
- Seating place in car park and terrace area.
- White tile in terrace (Heat proof tile)
- Six passenger Automatic (Emperor) lift up to Terrace will be provided.
- CCTV Provision, Video Door Phone system, Genset for Common areas.
- SOLAR PANEL POWER SYSTEM provided in Terrace for Common Meter.

DOORS AND WINDOWS:

- MAIN door with TEAK WOOD, Godrej lock, viewing lens, brass hinges, brass handles, and tower bolts.
- Bed room doors with TEAK WOOD frames and single leaf MASONITE shutter.
- Bathroom doors with TEAK WOOD frames and single leaf Wood Plastic Composite (WPC Door) shutters.
- Open type UPVC window and safety grills.
- French door with UPVC Sliding type.
- VENTILATORS with TEAK WOOD frames, MS grill and provision for exhaust fan.

TILES AND GRANITE:

- Living, Dining, kitchen and Bedrooms floorings shall be provided with 2'9" x 2'9" Vitrified tiles of brands like Kajaria/Johnson/Somany (Basic cost Rs. 60.00/ Sq. Ft.)
- Bathroom wall tile for 7' 0" height (Basic cost Rs. 45.00/ Sq. Ft.)
- Kitchen wall tile up to 2'0" height (Basic cost Rs. 45.00/ Sq. Ft.)
- Anti-skid bathroom floor tiles (Basic cost Rs.45.00/Sq. Ft.)
- Kitchen platform with high grade polished Black GRANITE top with beading full rounded edges (Basic cost Rs. 135.00/ Sq. Ft.)
- Stainless Steel single bowl sink in kitchen.

SANITARY WARES AND FITTINGS:

- EWC Wall mounted closet with Parry ware brand for all toilets.
- Wash basin with PARRYWARE brand in Dining and Master bedroom toilet.
- Cockroach Trap in all toilets and kitchen sink.

PLUMBING:

- Two Taps in the kitchen for Metro water and bore water each.
- Single Lever High Flow Diverter (Jaquar) for hot and cold water.
- All other Plumbing fittings with PARRYWARE brand
- All Internal plumbing water lines CPVC pipes and for External plumbing water lines PVC pipes are used.

ELECTRICAL:

- 3 Phase Electric supply connection with manual phase change over facility for each flat.
- MCB / RCCB with Anchor Panasonic/Greatwhite.
- Modular Switches & Sockets of Anchor Roma/Greatwhite/Equivalent Brand.
- Fire Retardant Copper Wire of Finolex / Orbit/Greatwhite.
- Split A/C provision for hall and all bedrooms.
- TV provision for hall and all bedrooms.
- Exhaust Fan Point in all Bathrooms and kitchen.
- Geyser Point in all toilets.
- Inverter wiring in all rooms.
- Water Purifier & Chimney point in kitchen.
- Inverter provision in balcony.
- Night lamps point in all bedrooms.
- One point in Stilt floor for Car washing (vacuum cleaners).

PAINTING:

- Internal Walls and Ceiling finished with 2 Coats of Putty, 1 Coat of Primer & 2 Coats of Asian Emulsion paint.
- External Walls finished with 1 Coat of White Cement, 1 Coat of Primer & 2 Coat of weather proof Asian ULTIMA Emulsion paint.
- Doors other than entrance door with enamel paint.
- Main door with varnish (sealer finish / Melamine finish).
- M.S. Grills with two coats of enamel paint.

NOTE:

- Any Additions or Alterations required over the above Provisions shall be provided at EXTRA COST

